

# **GK Magic 2000**

**version 36.3**

**with side door and foot switch**



*User manual*  
*02/2018*

**CE**

Copyright © 2018 - All content of this document, particularly texts, photographs and graphics, is protected by copyright. The copyright owner is, if not explicitly marked otherwise, the company Georg Krämer GmbH & Co. KG, Neuhauserweg 14, A-4061 Pasching. All rights reserved, including the rights for reproduction, publication, editing and translation of both the whole document as well as of any parts thereof.



*Congratulations on your decision to purchase a GK Bathtub. You have acquired an Austrian quality product which will considerably ease the strain involved in patient care.*

*Due to their advanced ergonomic design, GK Bathtubs are simple and straightforward to use. In spite of that, we would ask you to study the instructions carefully before operating the bathtub. The detailed information contained in this manual will facilitate your practical work.*

**■ Contents**

<b>Intended use</b> .....	<b>3</b>
<b>For your safety</b> .....	<b>3</b>
<b>Components</b> .....	<b>4-5</b>
<b>Control panel overview</b> .....	<b>6</b>
<b>Functions</b> .....	<b>7-15</b>
How the control panel works .....	7
Standby mode .....	7
Activation card .....	7
Raising & Lowering the tub .....	8
Opening & Closing the door .....	8
Opening & Closing the drain .....	8
Filling the tub .....	9
Fill levels .....	9
Setting the temperature .....	9
Temperature display tub fill & shower .....	10
Temperature display tub .....	10
Shower .....	10
Underwater light .....	11
Shampoo & Bath additive .....	11
Time display .....	11
Hydromassage .....	12
Intensity setting for hydromassage .....	12
Duration setting for hydromassage .....	12
Sound & Vision .....	13
Disinfection .....	14-15
Flowmeter .....	14
Standard disinfection .....	14-15
Compulsory disinfection .....	15
<b>The bathing cycle</b> .....	<b>15-16</b>
<b>Troubleshooting</b> .....	<b>17</b>
<b>Maintenance / Service</b> .....	<b>18</b>
<b>Care &amp; Cleaning</b> .....	<b>19-20</b>
<b>Standards &amp; Regulations</b> .....	<b>20</b>
<b>Technical data</b> .....	<b>21</b>
<b>Identification plate</b> .....	<b>22</b>
<b>Transport, Storage, Recycling</b> .....	<b>22</b>

## ■ Intended use

Bathing system for bathing patients with restricted mobility in care institutes and hospital wards. It is operated by healthcare professionals. The possible height adjustment provides an ergonomic working environment for the personnel and helps keeping their spines healthy.

## ■ For your safety

- Ensure that this bathing system is operated and maintained only by trained personnel.
- Always check the water temperature with your bare hand (also when using the shower) before bringing the water in contact with the patient.
- Ensure that each client is assessed for its ambulatory capability, ensuring the client's safety when entering and exiting the bathing system (utilize handgrips, correct entry height, correct client transferring device, etc.).
- Never leave the patient unattended inside the bathtub.
- Ensure that the equipment is thoroughly cleaned after every use.
- When using disinfection, protect your skin and eyes. Heed all instructions on the disinfectant's container and material safety data sheet.
- Always make sure that the device is supplied with power. It may only be interrupted in emergency situations.
- Ensure that there are no objects right next to the tub to ensure a safe up and down movement. Disregarding this instruction can cause bad injuries or damage the device.
- Don't place any objects on top of the device, since due to movement or vibrations, they can fall off - also into the tub.
- Adjustments and repairs must be carried out by authorized and appropriately qualified persons only.

**Caution:**



***The safety rules and instructions in this operating manual must be observed in order to ensure safe and proper use of the equipment. All claims under guarantee become void if these requirements are not met.***

■ Components



- |                                      |                      |
|--------------------------------------|----------------------|
| 1. Disinfection                      | 8. Overflow          |
| 2. Lid                               | 9. Hydromassage jets |
| 3. Shower                            | 10. Drain            |
| 4. Control panel                     | 11. Grab handle      |
| 5. Mixer                             | 12. Door with handle |
| 6. Shampoo & Bath additive dispenser | 13. Foot switch      |
| 7. Fill in spout                     |                      |

## Components



- Flowmeter with concentration table

- Box for care and disinfection liquids



- Hydromassage jet

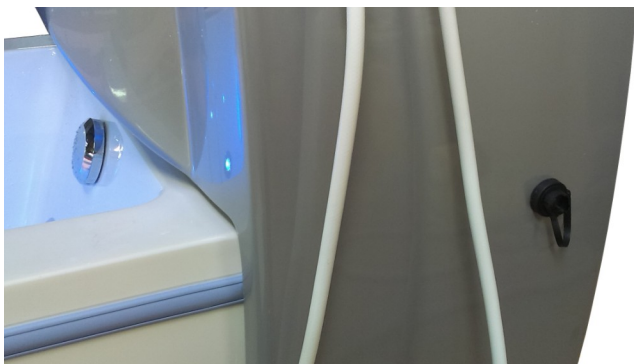

- USB port

## ■ Control panel overview

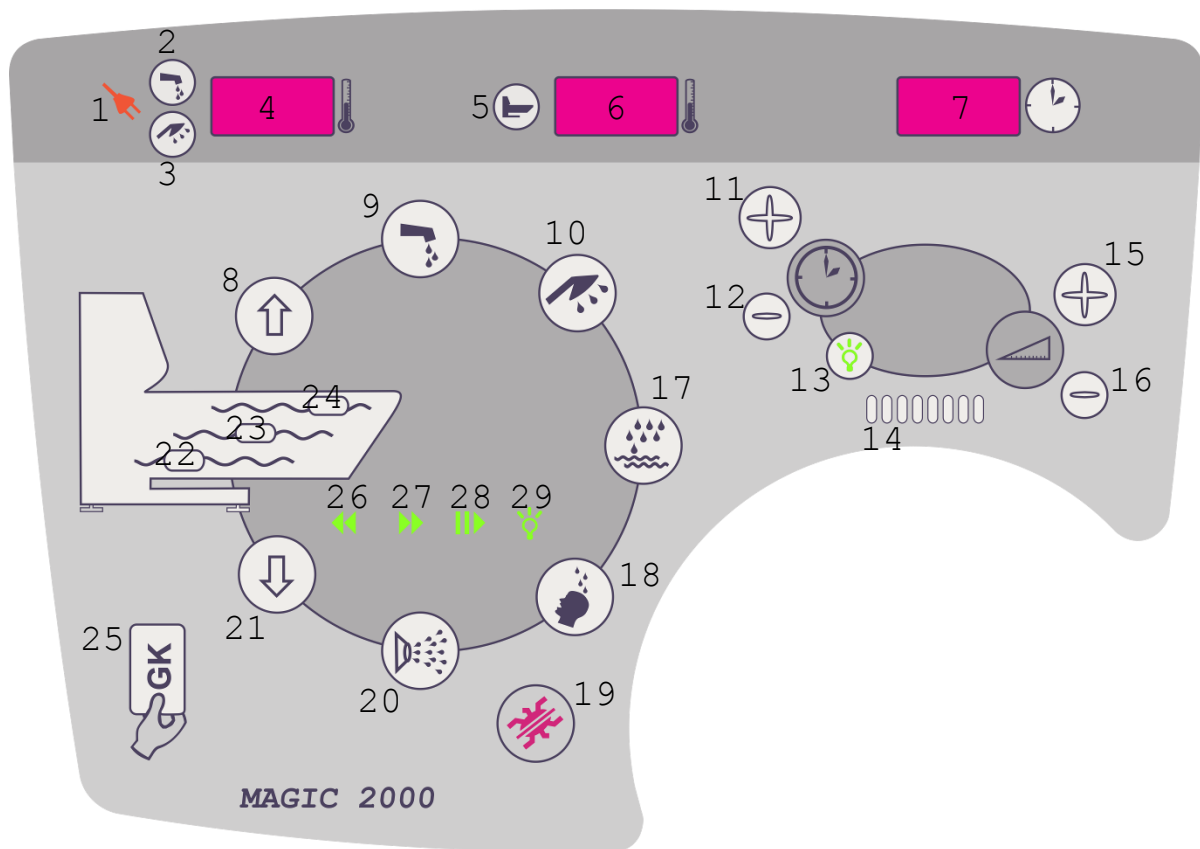

- |   |                                      |
|---|--------------------------------------|
| 1. <b>Symbol</b> Missing power supply     | 15. <b>Button</b> Intensity +        |
| 2. <b>Symbol</b> Tub fill temperature     | 16. <b>Button</b> Intensity -        |
| 3. <b>Symbol</b> Shower temperature       | 17. <b>Button</b> Bath additive      |
| 4. <b>Display</b> Tub fill & Shower temp. | 18. <b>Button</b> Shampoo            |
| 5. <b>Symbol</b> Tub temperature          | 19. <b>Button</b> Disinfection       |
| 6. <b>Display</b> Tub temperature         | 20. <b>Button</b> Hydromassage       |
| 7. <b>Display</b> Time                    | 21. <b>Button</b> Down               |
| 8. <b>Button</b> Up                       | 22. <b>Button</b> Minimum fill level |
| 9. <b>Button</b> Tub fill                 | 23. <b>Button</b> Middle fill level  |
| 10. <b>Button</b> Shower                  | 24. <b>Button</b> Maximum fill level |
| 11. <b>Button</b> Time +                  | 25. <b>Sensor</b> Activation card    |
| 12. <b>Button</b> Time -                  | 26. <b>Button</b> Back               |
| 13. <b>Button</b> Underwater light        | 27. <b>Button</b> Next               |
| 14. <b>Display</b> Intensity              | 28. <b>Button</b> Play/Pause         |
|   | 29. <b>Button</b> Lights             |



## ■ Functions

### How the control panel works

Generally we can say that a lit button signals the availability of the corresponding function (with the exception of Sound & Vision - for details see the corresponding chapter). When you press the button you activate its function and the light starts flashing. To stop the function, just press the button again. When there is no backlight behind the button, then the function is not available at the moment (for instance: disinfection is not available when the tub is full).

### Standby mode

If the tub is empty and for 10 minutes no function is activated (or in case that the main switch of the bathtub has been switched on), then the bathtub goes into standby mode. In this mode all functions are deactivated (with the exception of Sound & Vision, which gets "frozen" in the state which it is in at that moment) and locked. Only the sensor "ACTIVATION CARD" is illuminated with a green backlight.

The standby mode a) prevents unauthorized use of the bathtub and b) helps to save energy since due to the deactivation of almost all functions the bathtub uses less electricity.

In order to return to normal mode, please, use the activation card (see next subchapter).

### Activation card



To use the tub again when in standby mode, gently swipe the magnetic activation card over the green backlit sensor "ACTIVATION CARD". After 1-2 seconds the device should return back to normal mode.

**Note:** Optionally you can also reactivate the bathtub without the activation card. This option can be set in program mode. If it has been turned on, then you can reactivate the bathtub by pressing any button. (In case that the function behind the pressed button is available, it will also get activated immediately, e.g. raising and lowering.) This means that with this option turned on, the standby mode only helps to save energy but does not prevent unauthorized use of the bathtub.



### Raising & Lowering the tub

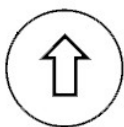

The "UP" and "DOWN" buttons are used to raise or lower the tub. The movement continues until the button is released again. In the upper and lower end positions the tub stops automatically. In the event of power failure the bathtub can only be lowered, which is powered by the emergency battery. The movement is a bit slower in this case than usual. Additionally the symbol "MISSING POWER SUPPLY" is illuminated.

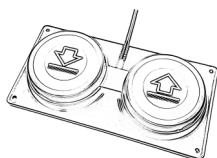
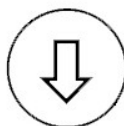

Alternatively to the buttons on the control panel the tub can also be raised or lowered by means of the foot switch. It works with air pressure and is connected to the electronics through thin air filled plastic tubes. The higher air pressure, when stepping on the switch, activates the corresponding function on the electronics (inside the casing). Thus, the foot switch is separated from all electricity and may get wet without concerns.

**Note:** The foot switch is not included with every bathtub as it is an option.

### Opening & Closing the door

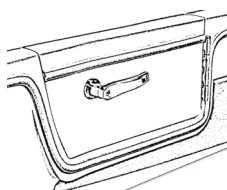

The door in the side of the bathtub can be opened and closed manually only. In order to open it the handle must be turned clockwise. In order to close it, counter-clockwise. From the open to the closed position of the handle, a rotation of about 60-70° is necessary (a bit less than a quarter of a circle).

### Opening & Closing the drain



In order to close the drain, ensure that the drain plug is in place. Then turn the chromed overflow clockwise. In order to open it, turn the overflow counter-clockwise. (It is not necessary to remove the drain plug.)

## Filling the tub



When you press the button "TUB FILL" the tub starts filling. The button starts flashing and the symbol "TUB FILL TEMPERATURE" lights up. The water now flows into the bathtub until the set filling level (see "Fill levels") has been reached or the button is pressed a second time. Once the set filling level is reached the button is no longer illuminated until either a higher filling level is chosen or water has been drained. If you want to add more water after the automatic stop, holding the button down for more than 2 seconds will continue filling until you release it, despite it being dark. Of course you can also add more water with the shower.

## Fill levels

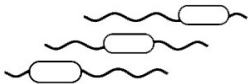

This device features three automatic fill levels, saving valuable caregiver time. The active one is indicated by a lit button and can be changed by pressing the new level for 1-2 seconds. The filling always stops, when the water reaches the selected level.

## Setting the temperature

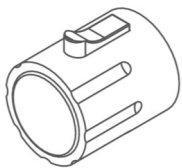

You can set the temperature for tub fill and shower continuously. To do that, turn the knob of the mixing valve to the desired position. The used temperature will be shown in the left display.

### Note:

For safety reasons the temperature is mechanically limited to 38 °C (standard mixer). To override this security appliance, press the button on the knob. Thus it is possible to turn the knob further and set a higher temperature.

### Caution:



***When setting the temperature to a value above 38 °C, set it back to 38 °C or lower as soon as possible! In the meantime, while the temperature is overridden, use extreme caution with the hot water.***

### Temperature display tub fill & shower



This display shows the current tub fill respectively shower temperature when they are in use. If the tub fill is active, the symbol "TUB FILL TEMPERATURE" is illuminated additionally to the flashing button "TUB FILL". If the shower is active, the symbol "SHOWER TEMPERATURE" is illuminated additionally to the flashing button "SHOWER". If tub fill and the shower are active at the same time, both will have the same temperature since there is only one mixing valve. If none of these two functions are active, then the display remains empty.

**Caution:** *Always check the water temperature with your bare hand (also when using the shower) before bringing the water in contact with the patient.*



**Note:** The symbols next to the temperature displays only serve as status indicators. You cannot activate any functions with these.

### Temperature display tub



This display shows the current tub water temperature inside the tub starting from a water level of about 8 cm. If the water level is lower, then the display remains empty. The symbol "TUB TEMPERATURE", which is illuminated when the display is active, should help to avoid confusion.

**Note:** The symbols next to the temperature displays only serve as status indicators. You cannot activate any functions with these.

### Shower



The shower can be used at any time (except during certain parts of the disinfection procedure). To do so, simply take the white hand shower from its holder and press the button "SHOWER". The button starts flashing and the symbol "SHOWER TEMPERATURE" lights up. Press and hold the trigger on the hand shower's handle to begin showering. When you press the button "SHOWER" again, the shower is deactivated and the pressure is automatically taken out of the hose.

## Underwater light



The underwater light, if installed (being an alternative to the "Vision" function), is available only when the tub is filled with water at least up to the middle level. Then the button "UNDERWATER LIGHT" lights up and the function becomes available. By pressing the illuminated button the underwater light is switched on and the button starts flashing. The underwater light slowly changes between 7 colours. (It cannot be fixed to one colour.) By pressing the button again the underwater light is switched off.

## Shampoo & Bath additive



Both of these products, if installed, can be added once the water level measures about 8 cm or more. Once the device recognizes enough water in the tub, the buttons "SHAMPOO" and "BATH ADDITIVE" are enabled and illuminated. By pressing one of the buttons the corresponding dispenser pump starts running for as long as you hold the button. 5 seconds after each use the dispenser openings are automatically flushed with water for 2 seconds.

### Note:

The tube for the shampoo has a red marking on its suction end - the tube for the bath additive a blue marking at the alike spot.

If there is no liquid coming out of the system, make sure that both boxes are full. After installing a new box it might take a while to get all the air out of the tubes. You possibly have to use the function for a longer period of time.

## Time display



This display has two different usage cases. Firstly it displays the remaining time for therapy (hydromassage or ultra sound) and secondly it shows the remaining contact time for compulsory disinfection. If none of these functions is active, the display remains empty.

## Hydromassage

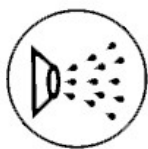

The hydromassage therapy, if installed, is available only when the tub is filled with water at least up to the middle level. In this case, the button is enabled and illuminated. By pressing the button the hydromassage jets are activated. The therapy will last until either the set time has elapsed (see "Duration setting for hydromassage") or the button is pressed again. If thereafter some overall treatment time is still left over, you can start the therapy again. After the full overall treatment time has been used up, the button will be darkened and disabled until the next bathing cycle. The therapy always starts on minimum intensity (see "Intensity setting for hydromassage").

**Caution:**



*When a massage hose coupling is installed, then the first jet, which contains the coupling for this option, will start with a time delay of approximately 10 seconds because of safety reasons.*

## Intensity setting for hydromassage

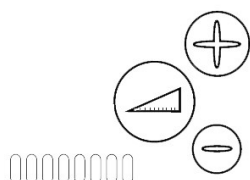

You can change the intensity for the hydromassage therapy. It always starts with the minimum intensity. To increase or decrease the value press either "INTENSITY +" or "INTENSITY -". When you reach the maximum or minimum values, then the corresponding button will be disabled. The selected intensity will be displayed on the LED bar.

## Duration setting for hydromassage

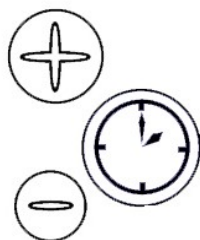

Initially the duration of the treatment is set to 5 minutes (see "Time display"). You can change the value by pressing either the button "TIME +" or "TIME -". When you reach the maximum or minimum values, then the corresponding button will be disabled. The maximum overall treatment duration is 20 minutes and can be apportioned at will. (In program mode it can be changed to a value between 10 and 45 minutes.)

**Note:**

The time cannot be set to zero. To pause or prematurely stop the therapy press the function button again.

## Sound & Vision

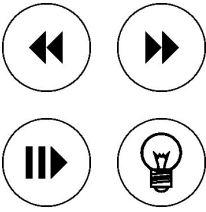

The optional feature "Sound & Vision" can playback music files which are stored on a USB stick on speakers build into the tub body. Furthermore, by means of LEDs on different sides it can suffuse the water with light in various colours.

If this feature is installed in your GK bathtub, then the buttons "PLAY/PAUSE" and "LIGHTS" will flash slowly in a rhythm of 3-4 seconds (ready mode).

### Sound

First of all ensure that a USB stick with readable music files (mp2, mp3, wma) is inserted into the USB port (on the side of the console). When pressing the button "PLAY/PAUSE" all the recognized music files will be played back, sorted by name (and the button starts to flash faster, about 1x/second). Furthermore, the buttons "NEXT" and "BACK" are enabled and illuminated continuously. When pressing these buttons the player switches to the next or previous (press 2x) track. After playing the last track playback continues again with the first track.

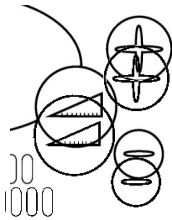

The volume can be adjusted by pressing the buttons "INTENSITY +" and "INTENSITY -". (These buttons first of all regulate the intensity of hydromassage/ultrasound. Therefore, the music's volume can only be adjusted when these functions are not active.)

By pressing the button "PLAY/PAUSE" during playback, it is paused (and the button starts to shine continuously). When pressing it again, the playback continues. In case the pause exceeds 30 seconds, the player resets itself to ready mode automatically. Thereafter, a further playback would again start at the very beginning. (In case the USB stick gets pulled during playback or if it was not in the port at the start of playback (the button still flashes about 1x/second), then this "empty playback" must be "paused" before (re-)starting a real playback.)

### Vision

When pressing the button "LIGHTS", the LED lights are switched to "slow continuous colour change" mode (and the button starts to flash faster, about 1x/second). - When pressing the button "LIGHTS" again, the colour currently visible in that moment is fixed (and the button is illuminated continuously). - Pressing the button a third time will switch back to ready mode and the LED lights off.

## Disinfection

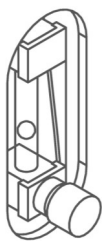

### Flowmeter

The flowmeter is used to adjust the mixture ratio between water and disinfectant. It is located at the back of the console. It can only be calibrated during a disinfection cycle while the disinfectant solution is flowing. The table next to it should help you to find the right value. Always follow the instructions of the disinfectant manufacturer. The Flowmeter must be calibrated after each connection of water tubes and after changes in water pressure and after changing the disinfectant's composition. During use of the tub, pay attention not to accidentally alter its setting.



### Standard disinfection

In order to be able to start the disinfection procedure 1) there must be disinfectant inside its container and 2) the tub must be empty. If both requirements are met, then the disinfection button lights up.

**Note:** If the disinfection container should be empty the disinfection button is flashing fast (~4x/sec.).

To start the disinfection procedure take the **red** hand shower from its holder and press the **disinfection** button. The button is flashing now. Spray all internal tub surfaces with the disinfectant solution.

**Caution:** *Protect your skin and eyes from the disinfectant solution. Follow all the instructions of the disinfectant manufacturer.*



Thereafter press the button again and put the hand shower back into its holder.

After the necessary contact time (according to the disinfectant's manufacturer's specifications) the tub must be rinsed thoroughly. To do so, take the **white** hand shower from its holder and press the **shower** button. Rinse all internal tub surfaces thoroughly.

When you deactivate the shower any hydromassage jets are activated briefly in order to remove the disinfectant solution from them. Ensure that no disinfectant solution residues are left behind inside the tub.

**Note:** For safety reasons the disinfection procedure - once started - cannot simply be aborted.

During the whole disinfection procedure most other functions are disabled, especially the tub fill.



**Note:** If the disinfectant runs out while spraying, the whole procedure **must** be restarted after replacing its container. Since the procedure cannot simply be aborted and the tub fill being disabled, therefore - once the disinfection procedure has been started - you cannot fill the tub again without enough disinfectant. However, the standard disinfection can be skipped altogether.



### **Compulsory disinfection**

In case the bathtub was programmed for compulsory disinfection, then you 1) must perform a disinfection procedure between two bathing cycles (it cannot be skipped) and 2) you must wait until the preset minimum duration for spraying and contact time has elapsed. (The factory setting for the minimum duration is 20 minutes. It can be changed in program mode to a value from 1 to 30.) The remaining duration is shown in the time display. Before it has elapsed, you cannot rinse the tub.

Other than that, the general procedure is identical to the standard procedure.

**Note:** With this type of disinfection you cannot start a new bathing cycle at all without enough disinfectant, since the compulsory disinfection cannot be skipped in between two bathing cycles and the procedure cannot be finished without enough disinfectant.

## ■ The bathing cycle

- Insert the drain plug into the drain. Close it.
- Adjust the tub shorter according to the body length of the patient and put the pillow into the right position.
- To start filling the bathtub, press the button "TUB FILL" and select a pleasant fill temperature for the patient.

**Caution:** *Always check the water temperature with your bare hand (also when using the shower) before bringing the water in contact with the patient.*



- Press the button "MINIMUM FILL LEVEL" for 1-2 seconds (until it lights up). Thereby, the water flow stops automatically as soon as the water level reaches up to close below the doorstep.

- Once the water flow has stopped, help the patient into the bathtub and close the door.

**Caution:**     *Never leave the patient unattended inside the bathtub.*



- Select the desired overall fill level and press the button "TUB FILL" again in order to continue filling.
- To add bath additive to the water (if installed available from a water level of about 8 cm) press the button "BATH ADDITIVE" for as long as you want to add more.
- Bring the bathtub to a comfortable working height.
- If you want to use the shower at any time during the bathing cycle, simply pick up the white hand shower from its holder and press the button "SHOWER". To start showering press the trigger on the hand shower.
- To dispense shampoo (if installed) press the button "SHAMPOO" for as long as you want more, while keeping your hand under the shampoo dispenser.
- If so desired by the patient, activate any available therapy treatment. Choose a suitable intensity and duration and wait until the time has elapsed.
- To finish, turn the chromed overflow knob in counter clockwise direction, in order to open the drain. Lower the bathtub and help the patient out of the water. BEFORE opening the door, ensure that the water level has dropped below the doorstep.
- Before you start a new bathing cycle you should thoroughly clean the bathtub.

### ■ Troubleshooting

**Tub fill doesn't work even though the function is active and the light is flashing.**

Check all the sieves and valves for dirt. If the problem still exists, then the electronic has to be checked. Contact your GK representative.

**The temperature regulation doesn't work properly.**

The thermostatic mixer is adjusted at 3 bar water pressure at both supplies. If you have different water pressure it may be necessary to do a readjustment. If the water pressure is about right, possibly the cartridge is defective and has to be changed.

**Very little water runs into the tub.**

If the hot and cold water supply pressure deviate too much from each other, then the mixing valve cannot work properly.

**Disinfection doesn't work and the button is flashing very fast (about 4x/sec.).**

The disinfectant container is empty. Replace it with a full disinfection container.

**Disinfection doesn't work and the button is flashing very fast (about 4x/sec.) even though the container is full.**

The disinfection sensor is defective and has to be replaced.

**All the functions are disabled except the "UP" and "DOWN" buttons.**

Probably the tub is still in the disinfection cycle. Finish the procedure properly.

**No shampoo or bath additive is dispensed even though the button is flashing when it is pressed.**

If the corresponding box is not empty, then there probably is air in the tubes. Press the corresponding button for a longer time.

**The hydromassage/ultrasound button doesn't light up (with hydromassage/ultrasound being installed) even though there is more than enough water in the tub.**

The fill level sensor is defective and has to be changed.

**The tub fill does not stop automatically.**

The fill level sensor is defective and has to be changed.

**All the functions are disabled except the "DOWN" button and the symbol "MISSING POWER SUPPLY" is lit.**

No power supply detected. Try to solve this problem as soon as possible since otherwise the emergency battery will be completely emptied.

## ■ Maintenance

- Clean the bathtub after each bath (see chapter "Care & Cleaning").
- Regularly (at your own discretion) monitor the fill level of the disinfectant container (if installed).
- Regularly (at your own discretion) monitor the fill level of the shampoo and bath additive containers (if installed).
- Once a month, check the sieves in the hand showers and clean them if necessary.
- Once a month, check the proper condition of the shower hose and, if installed, of the disinfection shower hose, as well as of any externally visible connections.
- Once a month, check the bathtub for any cracks or other damages.

**Caution:**



*Should you notice any damage to the bathtub either during maintenance or at any other time, then the bathtub may not be used any further from that point onward, until the damage has been assessed and, if necessary, repaired.*

## ■ Service

At least **once a year** a service or safety inspection in accordance with Medical Device Directive (MDD) is mandatory.

- Remember that GK service is unmatched in quality and also with regards to warranty issues. GK will only consider itself liable for safety-related matters if repairs, modifications, etc. are exclusively carried out by our service team or by agents authorized by us.

In the event of problems occurring, clear and detailed information about symptoms, type and serial number (see "Identification plate") will help us to respond promptly.

## ■ Care & Cleaning

Always clean the plastic parts wet or damp but never dry.

*Any product used to clean or disinfect your GK bath must be free from any abrasive, alcohol & corrosive ingredients. Never use any kind of customary glass cleansers, solvents (e.g. acetone) or similar detergents or dilutions. Never use harsh or pointed utensils, e.g. rough clothes, scrubbing sponges, scouring pads or any tools. If you are in any doubt about your usual cleaning products please contact your GK representative before use.*

**Caution:** *Any damage caused by unapproved / unsuitable products will not be covered by the manufacturer's warranty.*



### **Dark grey and transparent plastic parts:**

The dark grey and transparent plastic parts may only be cleaned with a maximum of lukewarm water and, if needed, a mild dishwashing soap. We especially recommend our special plastics intensive cleanser (details on request). For these parts of the tub **only use very fine textured chamois leather or a microfiber cloth.**

For the best care for these parts we recommend our special anti-static plastics care product (details on request).

### **Remaining tub body parts:**

For the other mostly white parts, after use always rinse the bath tub thoroughly with the shower hose. Any dirt which adheres to the bathtub surfaces must be removed with a soft sponge or cloth and, if necessary, customary detergents (besides the above mentioned restrictions).

**We recommend using our approved shampoo and bath additive products with your GK bath.** Other products may cause more persistent dirt being harder to clean.

**We also recommend for you to polish the white bath tub body once a month with car polish cream.** This will give the bathtub a smooth, water repellent surface and will make routine cleaning considerably easier - it will also enhance the appearance of your GK bath.

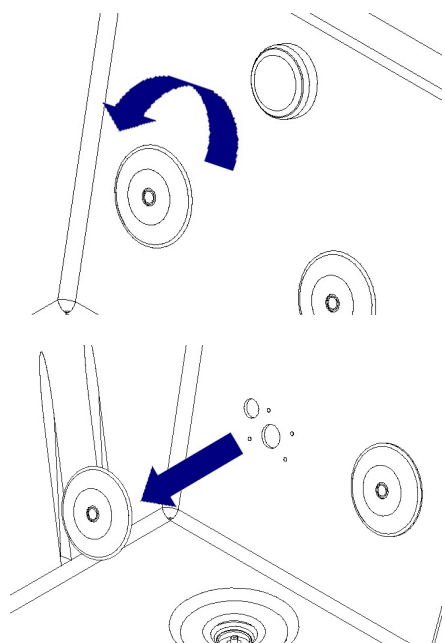

From time to time the hydromassage jet covers should be removed and be cleaned together with the inlet and outlet apertures separately.

To do so, unscrew the jet covers in counter-clockwise direction off of the tub surface (see pictures). Now clean the covers, the inlet aperture and the outlet aperture thoroughly with a suitable cleaning cloth.

**Note:** Do not use excessive force when re-assembling the jet cover.

If you have any questions, please, contact your GK representative.

## ■ Standards & Regulations

The bathtub complies with the essential requirements pursuant to Appendix I of the Medical Device Directive 93/42/EEC.

In accordance with the classification regulations pursuant to Appendix IX of the Medical Device Directive 93/42/EEC, the bathtub is a Class I medical device.



### ISO 9001

Our production is subject to a quality management system according to ISO 9001.



### CE mark

The CE mark has been affixed as proof of its compliance with the legal requirements of Appendix I of the Medical Device Directive 93/42/EEC.

■ **Technical data**

- Bathtub **GK Magic 2000**:

- Voltage: AC 230 V / AC 115 V
- Frequency: 50 Hz / 60 Hz
- Power consumption: 800 VA
- Fuses: 10 A time-delay  
12.5 A time-delay
  
- Protection class: I
- Degree of protection: IPX4
- Protection type: Type B 
  
- Lifting weight: 400 kg
- Lifting height: 400 mm
  
- Maximum length: 2240 mm
- Maximum width: 930 mm
- Maximum height: 1250-1650 mm
  
- Time of guarantee: 2 years  
(besides wear parts)
  
- Classification according to MDD 93/42/EEC: **Class I**



## ■ Identification plate

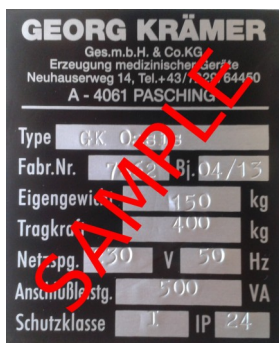

### Identification plate

This plate give you some information's about the Product, for instance type, production date, serial number,...

## ■ Transport, Storage, Recycling

### Operating conditions

Max ambient temperature:	40 °C
Max relative humidity:	80 % not condensed at 20 °C
Atmospheric pressure range:	500 hPa to 1060 hPa

### Transport and Storage

Ambient temperature range:	-20 °C to 60 °C
Relative humidity range:	80 % not condensed at 20 °C
Atmospheric pressure range:	500 hPa to 1060 hPa

### Recycling

Package:	Wood and corrugated cardboard, recyclable
Product:	Electric, steel and plastic parts shall be separated and recycled



Georg Krämer Ges.m.b.H. & Co. KG

A-4061 Pasching  
Neuhauserweg 14

Tel. +43 / (0) 7229 / 64450  
Fax +43 / (0) 7229 / 70664  
[service@gk-medizinmechanik.at](mailto:service@gk-medizinmechanik.at)  
[www.gk-medizinmechanik.at](http://www.gk-medizinmechanik.at)